

KEY PLAN
(PREVIOUS PROPOSAL)
AS PER COMPOSITE PLAN
SECTOR B-4, PKT-3

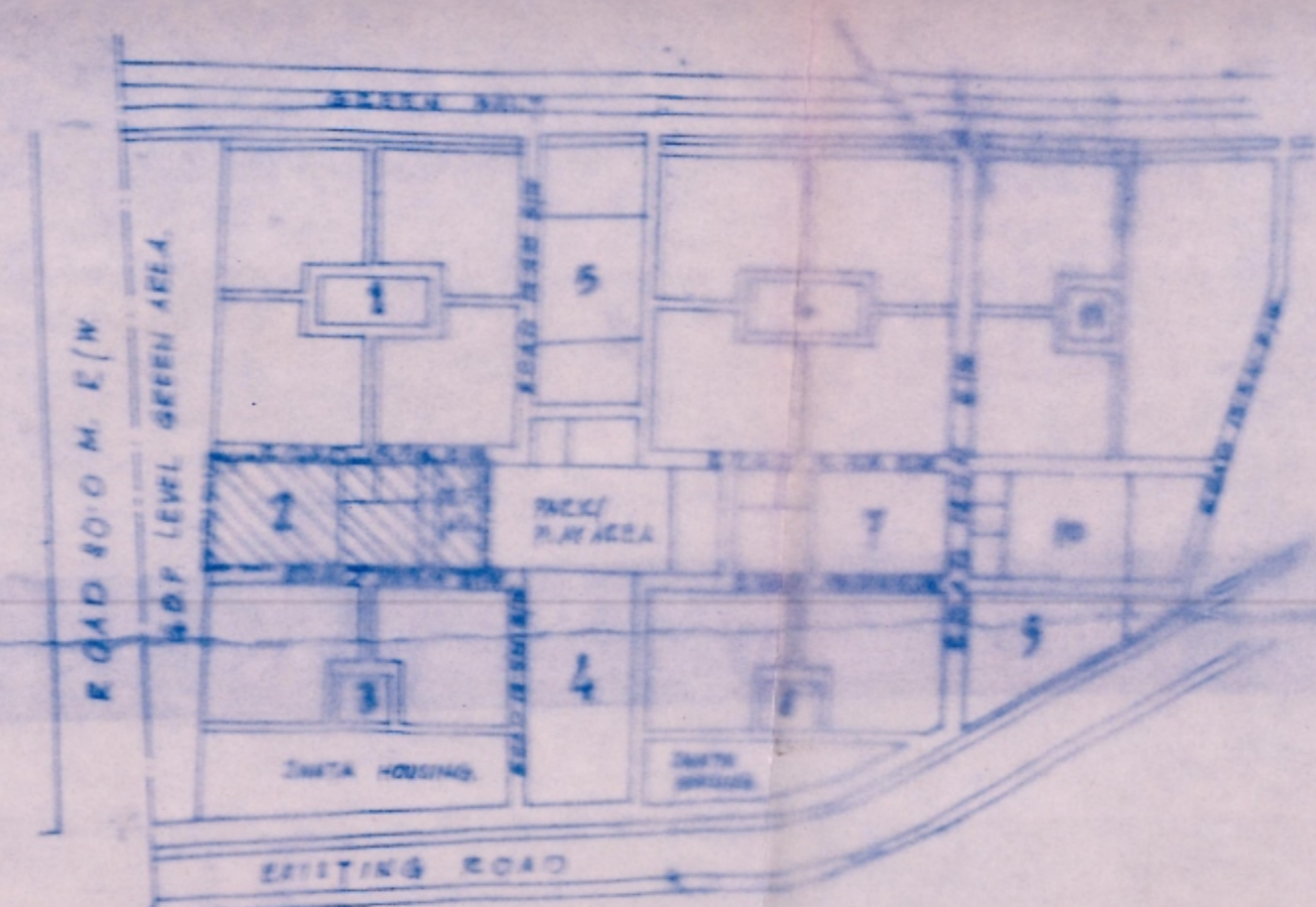

KEY PLAN
(REVISED PROPOSAL)
SECTOR B-4, PKT-2

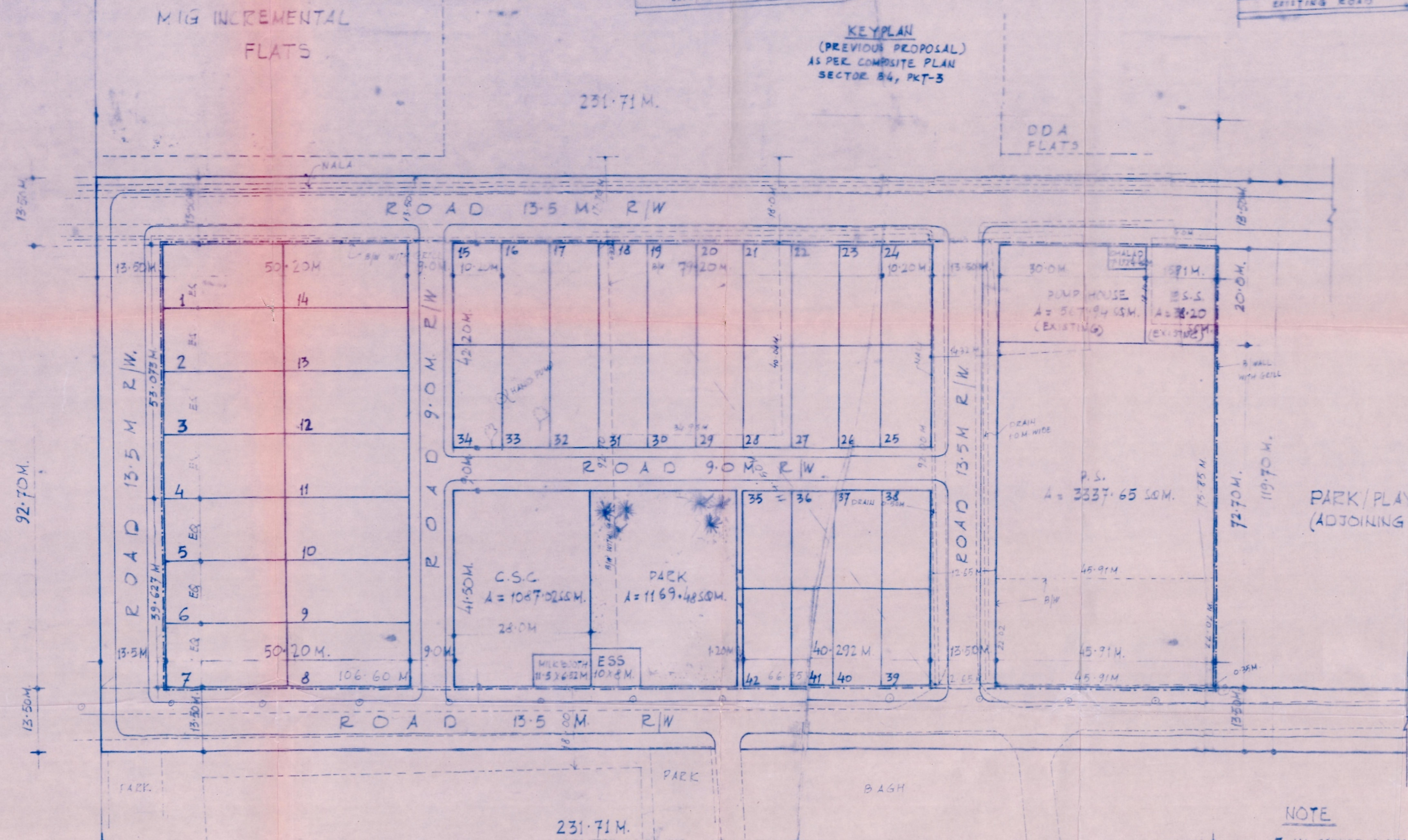

TOTAL AREA OF SCHEME
231.71 X 92.70 M = 21,477.33 SQ.M. (INCLUDING FACILITY ROAD ETC.)

LAND USE	AREA	%
AREA UNDER PLOTS	= 8,006.93 SQ.M.	37.32
FACILITIES (P.S., PUMP HOUSE, E. S.S., METER STATION, SHAWABAD)	= 46.10 SQ.M.	0.21
C.S.C.	= 1087.12 X 5.01 M.	5.04
PARK	= 1169.48 X 5.44 M.	5.44
ROADS & PATH	= 4243.67 X 19.94 M.	19.74

DETAIL OF PLOTS

SL. NO.	SIZE OF PLOT	AREA OF PLOT	NO. OF PLOTS
1 TO 4			4
11 TO 14	13.244 M X 25.10 M	332.92 SQ.M.	4
5 TO 10	9.209 M X 25.10 M	233.15 SQ.M.	6
15, 24, 25, 34	10.20 M X 21.10 M	215.22 SQ.M.	4
16 TO 23			8
26 TO 33	9.90 M X 21.10 M	208.89 SQ.M.	8
35 TO 42	10.07 M X 20.75 M	209.00 SQ.M.	8

NOTES -
1. EARLIER THE LAY OUT PLAN FOR ALTERNATIVE PLOTS WAS PREPARED BASED ON THE SURVEY SUPPLIED BY ADGD DATED 25.6.97 FOR SECTOR B-4, POCKET-3.
2. TOTAL 42 NOS OF PLOTS WERE CARVED OUT IN THE LAY OUT PLAN ON ACCOUNT OF ORCHARD/TREES 27 PLOTS ARE APPROXIMATELY AS PER ORDER OF THE ADGD DATED 21.6.97 AT PARCEL NO. 30/M IN FILE NO. DIR/UP/97/269/12/11 AN ALTERNATE SITE PROPOSED I.B. SECTOR B-4, PKT-2, NOT SURVEYED AND PLAN PREPARED FOR EQUAL NO. OF ALTERNATIVE PLOTS BASED ON SURVEY VIDE DIR. NO. 5/422/93 DT. 26.7.97.
3. NOW THE REVISED PROPOSAL HAS BEEN MODIFIED ON THE BASIS OF FRESH SURVEY/DIAMENSIONS GIVEN BY ADGD DT. 16.6.2002.
4. LAND DEPTT. SHALL CHECK THE PLOTTING DIMENSIONS & AREA OF THE SITE BEFORE HANDING OVER THE POSSESSION.

DEV. CONTROL
THE COVERAGE AND FEE WILL BE GOVERNED AS PER MPO-2001.
LAY OUT PLAN OF SECTOR - B-4
POCKET-2, NARELA
(ALTERNATIVE PLOTS)

Scale 1:500	Date 15.3.2002	
Drawn by [Signature]	PLG. SECTY/ asstt dir सहायक निदेशक	
Director उप निदेशक	Dir. P.L.G./project planner परियोजना नियंत्रक	Drawing no. DIR/MP/14/99/377

NARELA PROJECT
नरेला परियोजना 377

NOTE
7. ALL CORNER PLOTS (RESIDENTIAL) WILL HAVE A CHAMFER OF 1M X 1M AT THE CORNER.
8. LAY OUT PLAN HAS BEEN APPROVED BY BY COMM. PLG ON 9.4.2002 AT PAGE NO 32/M IN FILE NO.F15 (145) 2002-NP
9. THE DEMARCATION OF PLOTS AS WELL AS SERVICES (WATER SUPPLY, SEWER LINES AND S.W. DRAINS) HAS BEEN LAID DOWN AT SITE AS INFORMED BY EXECUTIVE ENGINEER, ND-12/DDA VIDE LETTER NO-F3(72)03/ND-12/DDA/1246, DATED: 14/12/04. AT PAGE NO.96 IN FILE NO. F 15 (145) 2002-NP. exact three call out and park yet to be developed.

G.D.P. LEVEL GREEN AREA

MIG INCREMENTAL FLATS

DDA FLATS

FLATS
MIG. INCREMENTAL